

GGX125 Grease Guardian Installation Details

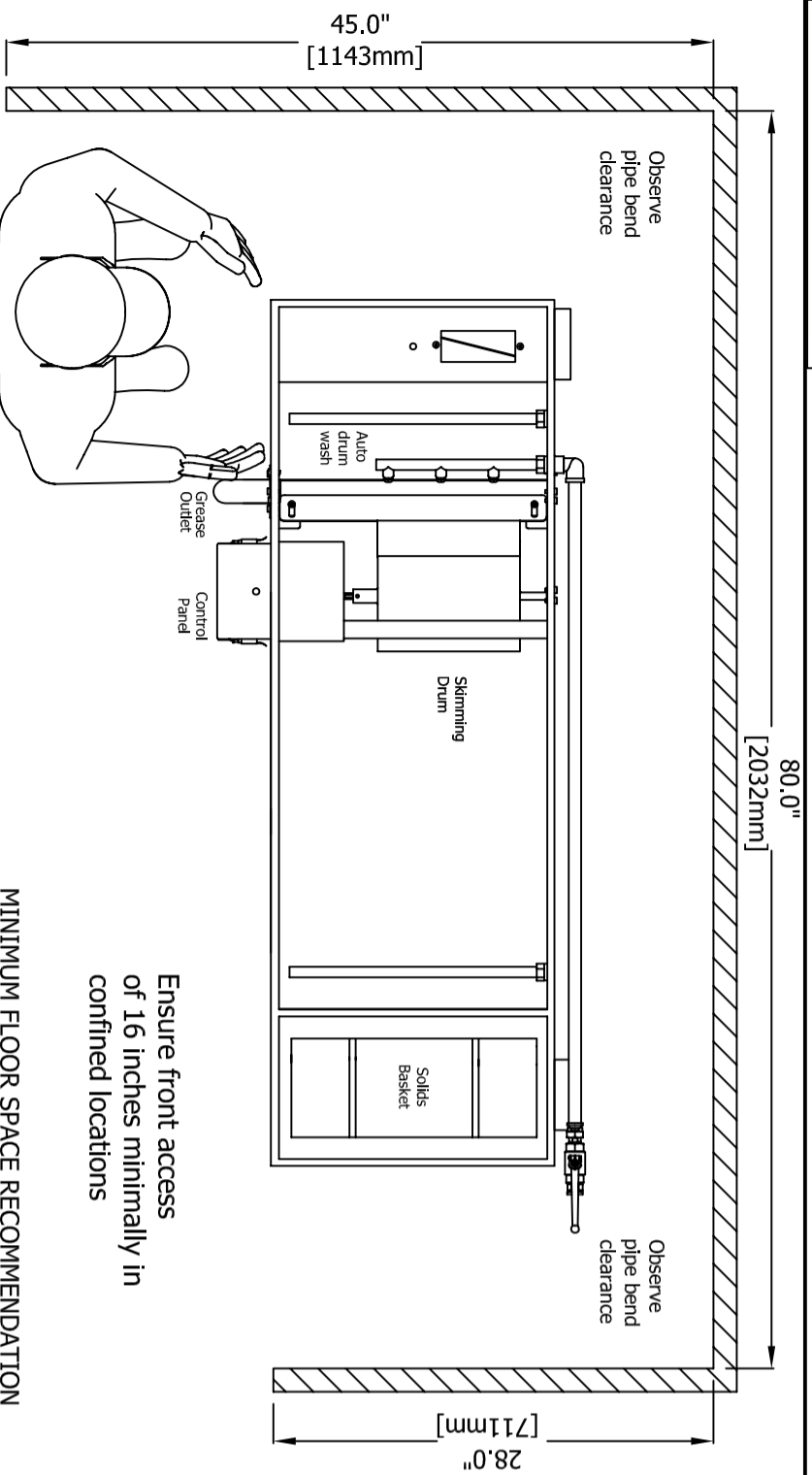

KEY INSTALLATION NOTES:

This unit is to be installed free standing normally at a lower level than the kitchen floor.
 Allow for the minimum dimensions shown.
 Keep outlet piping at a fall of $\frac{1}{8}$ " per foot (1:40).
 Use adjustable rubber pipe connectors as supplied.
 Only switch on after filling system to the required level
 Refer to manual for full installation details.

PRE START CHECK UP:

Ensure unit is positioned on a level surface and is plumbed in securely.
 Ensure electrical outlet is fitted with dedicated ground fault circuit breaker.
 Ensure that the unit is filled with water to the correct level.
 Set correct controller date and time as detailed in the manual.
 Ensure that collection receptacle is empty and securely in place.

SPECIFICATION:

Grease Guardian Model GGX125:
 Automatic grease removal unit, 16 gauge fully welded 304 stainless steel tank, stainless steel internal baffle plate, fully sealed air tight stainless steel lid and robust stainless steel clamps, stainless steel vertical lift solids strainer basket for easy disposal of solids, easy fit pipe couplings supplied, 125 gallons per minute flowrate, and skimming rate of 40 pounds per hour. The GGX125 is supplied with two rotating grease skimming drums with a manually operated internal wash system for the wiper blade and scum dispersion, integral gas trap, totally enclosed geared drive unit, two 600 watt immersion heaters with self regulating safety control, programmable controller with interface, energy saving mode and visual alerts. The GGX125 is suitable for floor and shelf type mounting. 3 year warranty as standard.

Electrical Details
 GGX125 110Vac, 1260 Watts, 11.5A

GGX125 Grease Guardian Standard Specification

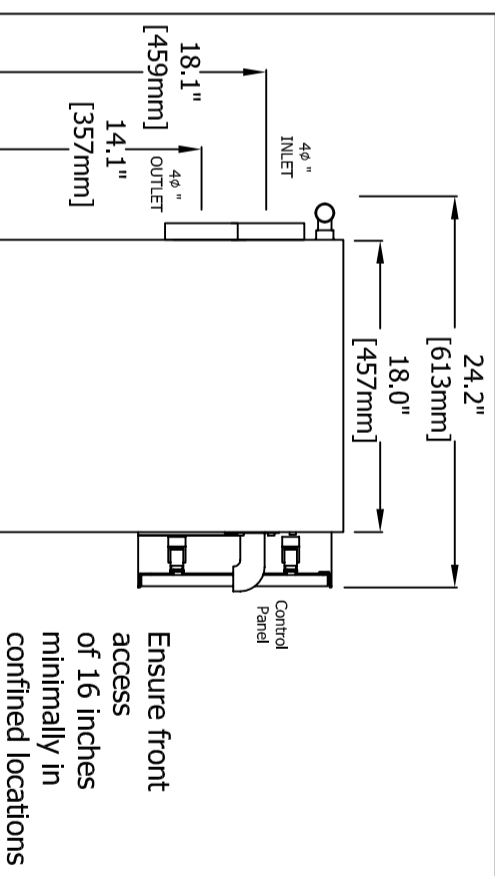
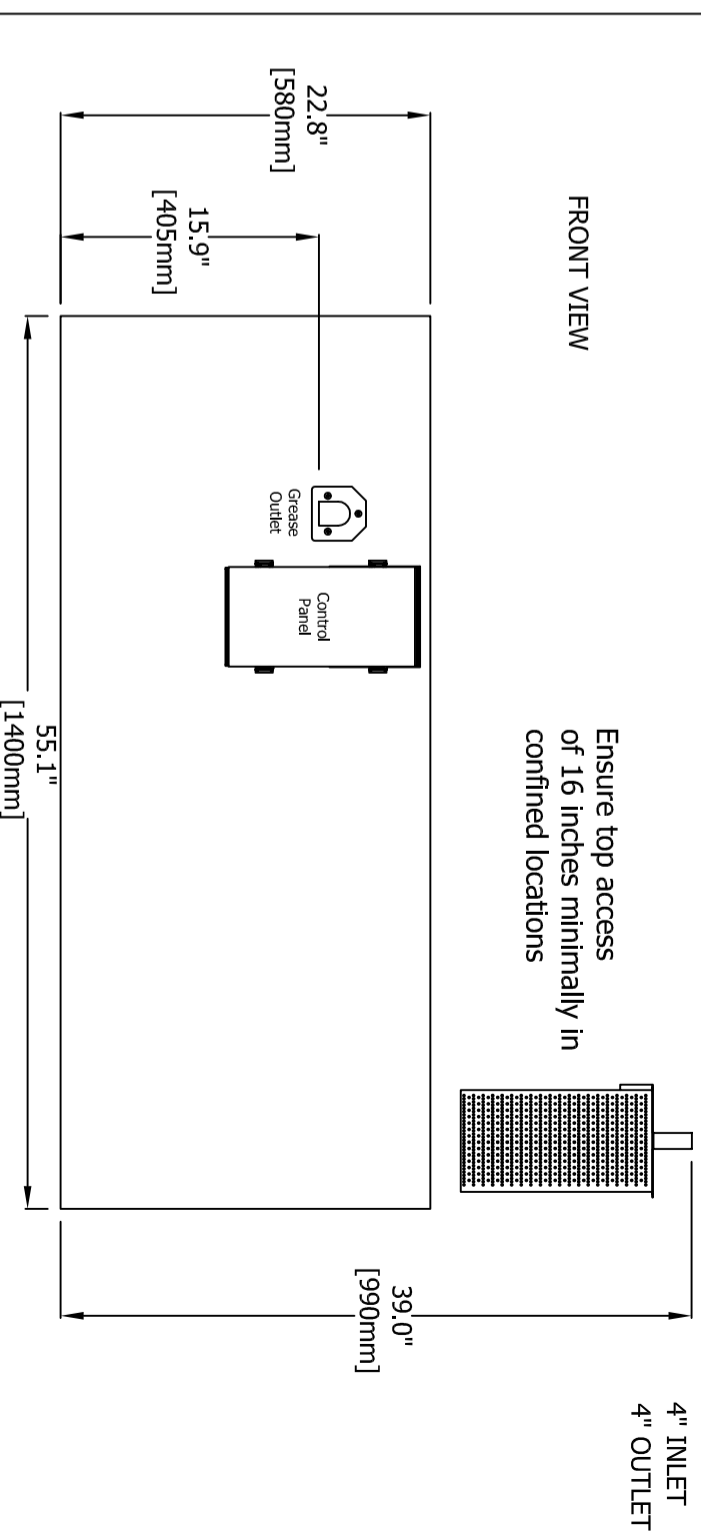

- GREASE GUARDIAN X STANDARD FEATURES:**
- 3 Year Guarantee
 - Fully Automatic Grease Removal Unit (AGRU)
 - 16 gauge 304 stainless steel welded tank
 - Fully sealed air tight lid
 - PLC/HMI automatic controller
 - Energy saving mode
 - Two skimming drums with manual spray bar wash
 - Wash-water conditioning system
 - Lift-out solids basket
 - Grease Guardian World asset management

TECHNICAL DATA

Weight _____ 260 pounds

Exterior Materials _____ 16 gauge AISI304 Stainless Steel

Interior Materials _____ AISI304 Stainless Steel & Acetal Components

Maximum Flow Rate _____ 125 GPM

Lift-out screen basket capacity _____ 2.5 gallons

Skimming Rate _____ 40 pounds per hour

Grease Retention Capacity _____ 300+ pounds

Wash water system operation requirements (minimum) _____ 12gpm/43.5psi (0.75ftres/s@3bar)

Programming/Control _____ 7day, 24hr multi-function PLC

Electrical Load _____ 110VAC, 1260W, 11.5A