

GGX7c Combi Guardian 230 VAC Specification

Front View

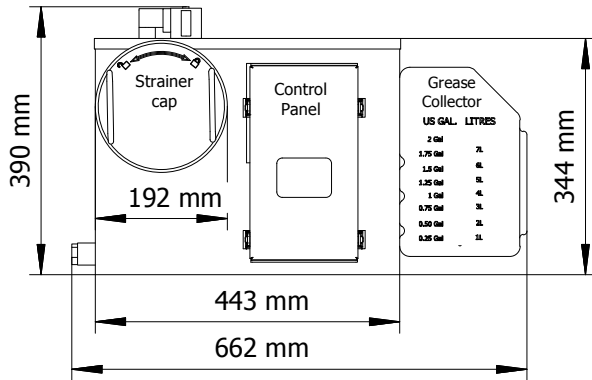

Right End View

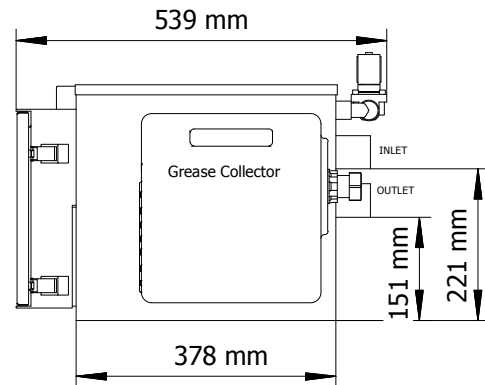

Footprint/Containment area

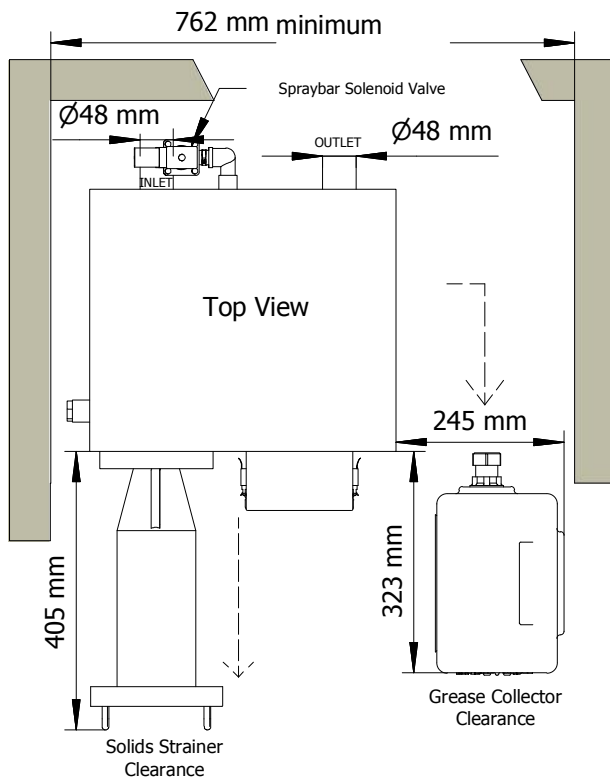

Standard Features

- Automatic grease removal mechanism
- Internal dry solids strainer
- Grease heating system
- PLC controller with LCD notifications
- Energy saving mode
- Building Management Control(zero volt contact for power status)
- Bidirectional Inlet and Outlet plumbing ports
- Quick Fit rubber couplings
- Automatic spray bar system fitted
- Pipework and power cabling concealed at rear.
- 3 year guarantee

Exclusions:

- RCD, IP socket, or any electrical supply devices beyond mains cord/plug as supplied.
- Pipework beyond inlet/outlet couplings /ventilation piping

Options: by FM Environmental on request:

- Tank support frame
- Upstream coarse solids strainer modules
- Externally mounted blower system (for surface scum dispersal)
- Sample valve (150mm additional length in outlet pipework required)

Key Installation Notes:

Allow for the minimum clearances shown, including clearance for pipe connections and user access to front of unit

Unit should be plumbed at a gravity fall (1:40 for maximum performance)

Control panel should be fully accessible to service personnel

Electrical supply is single phase. An RCD/ELCB rated 30mA must be installed for all Grease Guardian electrical supplies

Observe all local plumbing regulations for pipe venting, trapping.
Observe all local safety and hygiene regulations

Note: Not to be treated as an installation guide. Installation guide in full is issued on supply of system.

TECHNICAL DATA

| | |
|---------------------------|---|
| Weight | 30 kg (empty) |
| Material | Exterior, 16 gauge stainless steel, bright finish |
| Interior | Stainless Steel and Acetal Plastic Components |
| Tank Capacity | 25 litres |
| Maximum Flow Rate | 0.5Litres per Second |
| Grease Retention Capacity | 15 pounds/6.8kg |
| Solid Strainer Capacity | 6.6 pounds/2.99 kg |
| Skimming Rate | 3-5 litres per hour |
| Mains water required | __min 0.75 litres/s @ 3-6 bar (temp 40-60 C) |
| Progammng/Control | 24 hour, 7 day, multi functional digital |
| Electrical Load | 230VAC, 625Watts, 2.72 AMPS |